

IXOLIFT®

OPERATING MANUAL

DataLift 175 ML

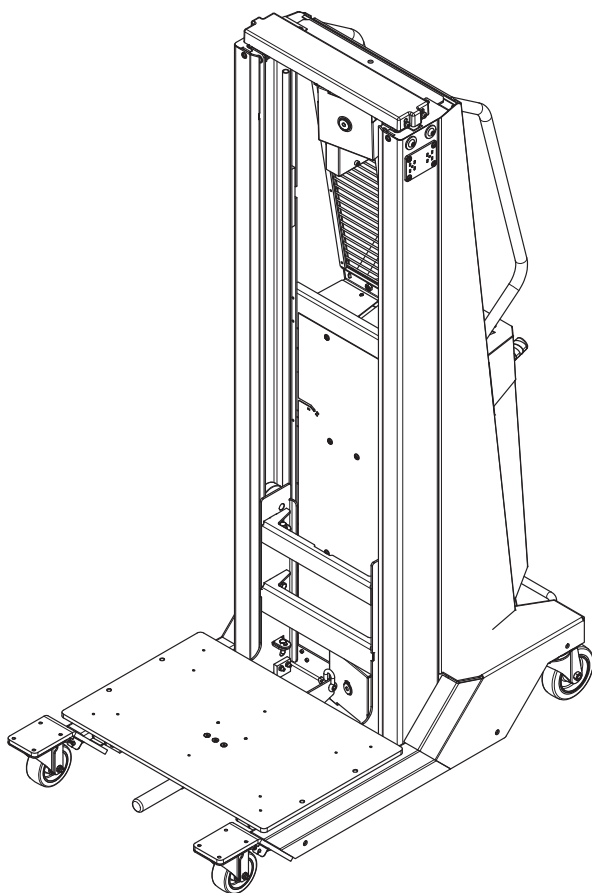

Please read this manual before using the product and follow the instructions it contains.

INDEX

GENERAL

INTRODUCTION	3
GENERAL	3
SAFETY INSTRUCTIONS	3
OVERVIEW OF THE MAIN COMPONENTS	4
USE OF THE PRODUCT	5
STICKERS.....	8
IDENTIFICATION	9
PRODUCT DATA	9
SAFETY PARTS AND WARNING SIGNS.....	10
UNPACKING, TRANSPORTATION AND STORAGE.....	11

WARRANTY AND MAINTENANCE

MAINTENANCE	13
CHECKLIST FOR MAINTENANCE / INSPECTION	14
TROUBLESHOOTING.....	15
SPARE PARTS.....	16
WARRANTY	16

INTRODUCTION

Thank you for putting your trust in the Ixolift products. We design all our products to solve all your lifting challenges.

Read the whole manual before using the machine.

Store this manual in a safe and proper way for use in the future.

GENERAL

This product is built for data centres to handle IT devices. Inspect the unit before operation, damaged units are not to be used. This device is used to lift and lower IT devices to the correct height. Do not operate this machine until the operator has read and fully comprehends the DataLift Operating Manual.

Please refer to national standards for usage education and training requirements.

SAFETY INSTRUCTIONS

- Read the warning signs on the DataLift and instructions in this manual before use.
- Do not operate the DataLift unless you are familiar with it and trained to do so.
- Do not use the DataLift unless you have checked that it is in perfect condition. Pay particular attention to the cable, wheels, platform handle, brake, chassis, control unit, mast, battery etc.
- Do not use on dirty floors or in explosive environments.
- Only work inside where no wind is present.
- Only use on level ground. Do not work on uneven ground.
- Do not transport persons on the platform.
- When lifting the platform, make sure that nobody stands or walks under the platform.
- Do not move the DataLift when goods are lifted above 500mm.
- Always centre the weight of the goods in the middle of the platform and near to the mast.
- Never load one sided. The centre of gravity of the goods should be in the middle of the platform.
- Observe the goods during transport. If the goods become unstable and threaten to fall/tilt, stop operation immediately.
- Do not load beyond the maximum weight limit.
- Suitable for indoor operation at a room temperature between +5 °C and +45 °C.
- Carry out the maintenance work according to the inspection schedule.
- The break should always be activated when lifting or lowering under load.

OVERVIEW OF THE MAIN COMPONENTS

1	WINCH CRANK	8	HANDLE BAR
2	DIRECTIONAL LOCK LEVER	9	PLATFORM
3	STOP-FLAG	10	FRONT WHEEL & LOCKING BOLT
4	USER MANUAL COMPARTMENT	11	BACK WHEELS
5	BRAKE LEVER	12	PULLEY
6	BUFFER	13	PULLEY
7	MAST	14	PLATFORM HANDLE

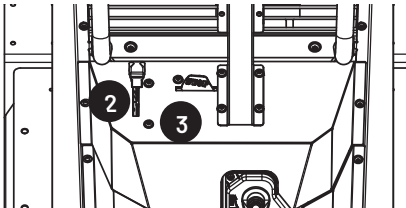
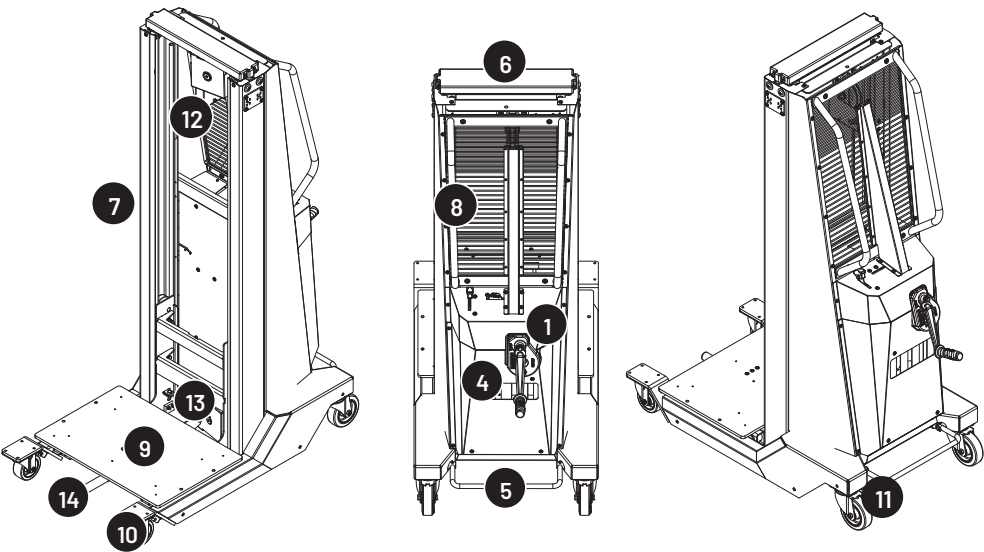

USE OF THE PRODUCT

GENERAL

Only use on level surfaces and never walk or stand under the loaded platform.
Always follow the safety instructions of this manual.

LIFTING AND LOWERING

The Datalift is manually powered by Hand. Always lower the platform when not ins use.

By turning the Crank (1) in clock direction the platform is lifted, counterclockwise it is lowered.
When the stop-flag (3) appears stop lowering – the bottom limit is reached, or the platform is blocked by an obstacle.

Always pay attention to obstacles before lifting or lowering.

The platform needs to be centered with the platform handle (14) before lifting and lowering.
Ensure maximum load is not exceeded.

MOVEMENT OF THE PLATFORM

The platform handle (14) moves the platform to the right and left. Move the platform handle downwards to unlock the platform and move the platform.

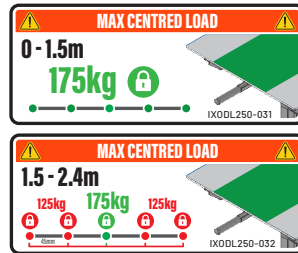
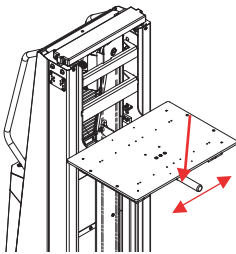

The max load for using the side travel depends on the lifting height.

Centre load is always **175kg max.**

When lifting higher than 1,5m the load needs to be reduced to 125kg for side movement.

BRAKE

Do not use excessive force to activate the break.

Do not use brake lever as a step.

Max. Load 30kg.

The brake is activated by pushing the brake lever (8) down. In the horizontal position the brake is inactive. It is a directional and swiveling brake for the back wheels. The front wheels are not affected. The break should always be activated when lifting or lowering under load.

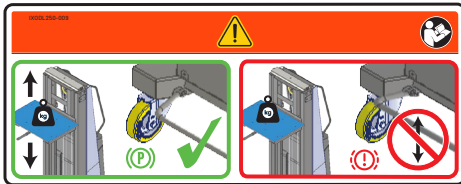

DIRECTIONAL LOCK

For activation and deactivation of this directional lock the directional lock lever (2) is used.

When pushing the DataLift in a straight line, the front wheels can be locked. The wheels will no longer swivel.

There is only one locking position. When the lock is activated, the wheels need to turn until the DataLift moves forward.

The wheels will click when the locking position has been reached.

This fixing bolt is spring loaded.

For swiveling mode, the directional lock lever (2) is pulled back. The front wheels will now move in any direction.



ACCESSORIES

The platform is equipped with 4 holes M10 for fixing accessories.
Read and understand the instructions of the accessories!
On the underside of the platform there are holes for attaching hooks if needed.

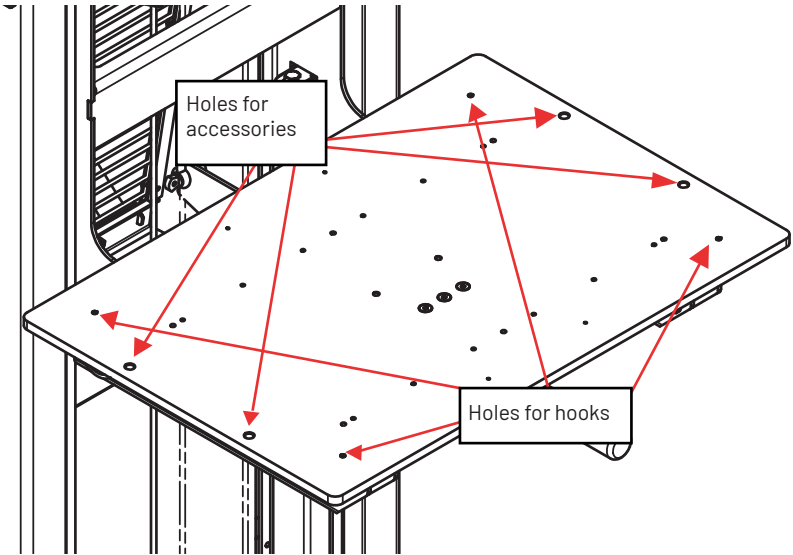

STICKERS

All safety stickers must be fixed to the DataLift for safe operation.



IDENTIFICATION

MANUFACTURER

IXOLIFT®

KALKKIMÄENTIE 2
FI-03100 NUMMELA, FINLAND

TYPE

DataLift 175_ML

SERIAL NO

XXXXXX

YEAR

2023

MASS

169 kg

MAX LIFTING CAPACITY

175 kg

PLATFORM HEIGHT

LOWERED

138 mm

RAISED

2.300 mm

CONFORMITY

Machinery Directive 2006/42/EC
EN ISO 3691-5:2020

MANUFACTURED IN FINLAND

TECHNICAL FILE

IXOLIFT-OL175_ML

SCAN THE QR CODE FOR IXOLIFT
PROFESSIONAL ONLINE SERVICES



CE

2023 / V1.0 / IXOLIFT_ML

pro.ixolift.com

PRODUCT DATA

CHARACTERISTICS

TYPE	UNIT	VALUE
DIMENSIONS	MM	1150x640x1700
LIFTING HEIGHT	MM	2300
WEIGHT	kg	169

WHEELS

TYPE	UNIT	VALUE
MATERIAL		POLYURETHANE
FRONT WHEEL DIAMETER	MM	100
REAR WHEEL DIAMETER	MM	125

DRIVE

TYPE	UNIT	VALUE
LIFTING CAPACITY	kg	175

SAFETY PARTS AND WARNING SIGNS

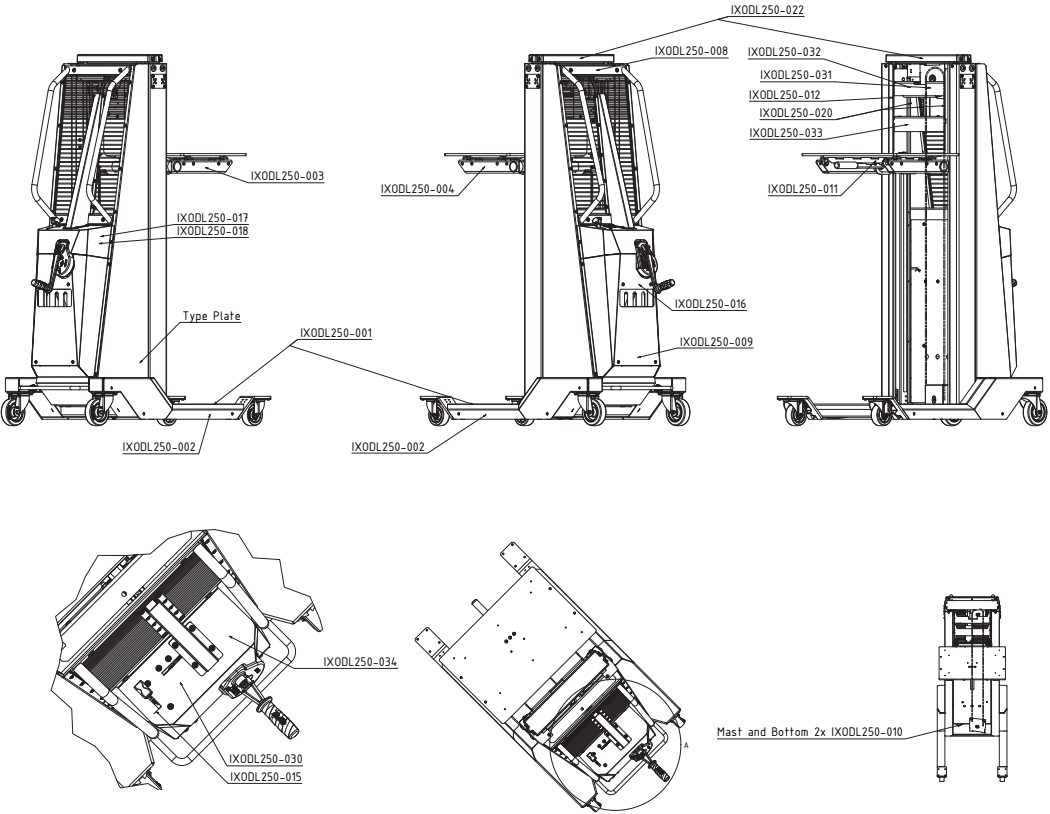

UNPACKING, TRANSPORTATION AND STORAGE

FIXING AND LIFTING POINTS

The DataLift is fitted with 4 fixing points for transport and one lifting point. Only use correct screws and lifting tabs.

Screws for fixing: Dimension M8, min. length 20 mm and class 8.8.

Lifting: hole width 11mm – use certified lifting hook, for min. 200kg.

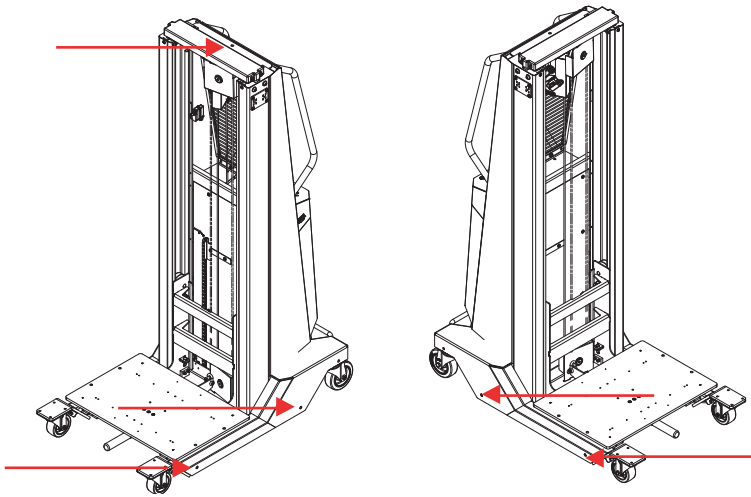

UNPACKING

The DataLift is delivered on a euro pallet and fixed with 4xM8 hexagon screws. There are two ramps supplied for unloading.

Only use attached ramps!

Wrench size: 13mm for fixing screws.

Wood screw bit: TX20

Wear safety shoes while working! Drive only backwards down the pallet!

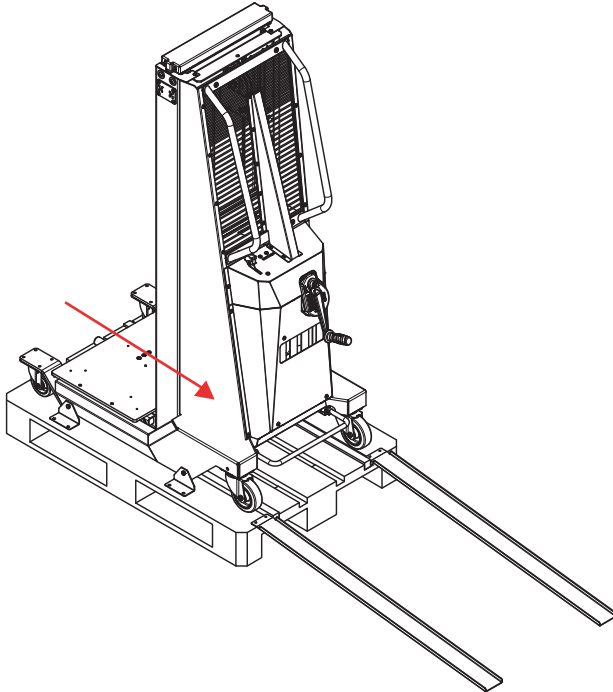

STORAGE

The DataLift is built for storage in temperatures of -10°C to 45°C .

The maximum humidity is 90% relative.

TRANSPORTATION

The unit is fixed with brackets and screws to the pallet. There is a ramp included with the DataLift when supplied from the factory. Only lift the unit at the manufacturers lifting points. Only unload the unit by use of the ramp. Always turn off the main switch during transportation.

Always lift the Platform a full turn with the winch for transportation, so that the Stop-Flag (3) is not active.

MAINTENANCE

OPENING OF THE BACK COVER

Park the DataLift safely and activate the brake (5). Loosen the 4 screws on the back cover and remove it. Do not operate the winch, when the back cover is open.

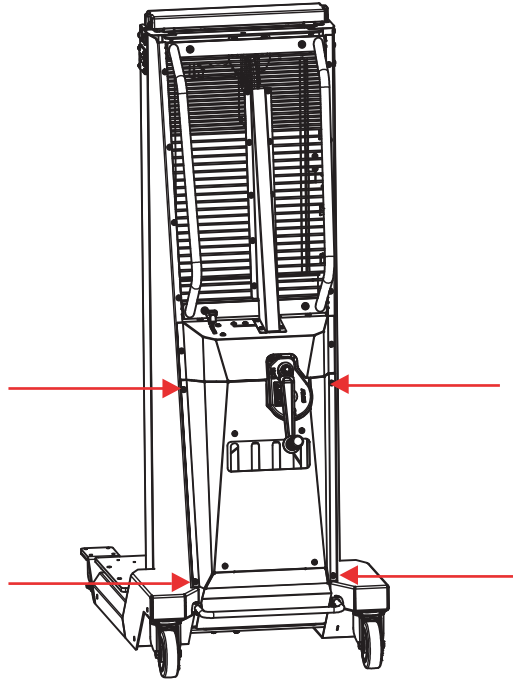

DAILY OPERATIONAL INSPECTION AND MAINTENANCE

Check the DataLift daily before use, paying particular attention to the wheels and the cable. Foreign objects can block the wheels, platform, mast, or cable. After use, remove any loads from the platform, lower it to the lowest position and complete inspection.

- Do a visual inspection for damage to the cable, scratches, damage, cracks, or loose screws.
- Check the function of the load pressure brake, the platform is not allowed to go down by itself.
- Check the condition of the DataLift when driving straight ahead.
- Check that the wheels move smoothly.
- Check brake function.

CHECKLIST FOR MAINTENANCE / INSPECTION

In addition to the daily inspection is the yearly inspection. National regulations may require additional inspections.

Remove the back cover.

Inspect the cable for:

- Wear and corrosion.
- Broken wires.
- Uneven strands, crushed parts, knots, uneven diameter.

In case of damage do not use the unit until the cable has been changed by a certified technician!

Inspect the pulleys:

- Check if there are cracks, wear, or distortion.
- Check fixing rings.
- Check bearings for smooth run/noise.

Inspection of the winch:

- The inspection needs to be done by a certified technician minimum once a year or after 400 lifts under full load.
- More information is at your local distributor available.

TROUBLESHOOTING

Problem	Reason	Solution
Load will not hold	Cable / band wound up incorrectly Direction of rotation incorrect when lifting	Fit cable / band correctly
	Brake worn or faulty	Replace winch
	Brake disc moist or oily	Clean or replace brake discs
Load pressure brake does not open	Brake disc mechanism or brake discs braced	Winch must not be under load! Loosen the brake by gently hitting the crank in the "lowering" direction with the palm of your hand You may need to block some gear wheels until the crank loosens. Grease the crank attachment thread
Difficult lowering with or without load	Crank attachment thread is fixed	Grease the crank attachment thread
Locking mechanism does not work	Stuck bowden cable	Remove dirt and check cables
	Locking bolt/clevis damaged	Adjust or replace
Brake does not work	Bolts are broken	Replace connection bolt from foot lever to axle
	Brake pad is worn	Replace wheel and bracket
	Tire is worn	Replace wheel and bracket

SPARE PARTS

According to Spare parts list.

Only use genuine DataLift spare parts!

WARRANTY

The warranty of two years from date of invoice covers materials, manufacturing, or construction defects. Natural wear and tear, improper handling or unauthorized modification are not covered by the warranty.

IXOLIFT LTD
Kalkkimäentie 2
FI-03100 NUMMELA
FINLAND

+358 20 741 5010
datalift@ixolift.com

www.ixolift.com

IXOLIFT®