

THIS COPY IS PROVIDED ON A RESTRICTED BASIS AND IS NOT TO BE USED IN ANY WAY DETRIMENTAL TO THE INTERESTS OF PANDUIT CORP.

PANDUIT PART NO. *	RECOMMENDED FASTNER	RECOMMENDED CABLE TIE	WEIGHT lbs. / 100 pcs (g) / 100 pcs
PPF2SV-S25-__	1/4" [6mm]	TAK-TY or HOOK & LOOP	3.25 (1474.2)

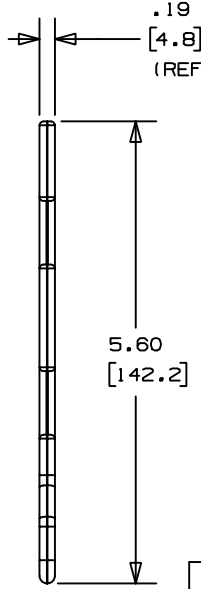

NOTES:
1. SEE CURRENT PRICE SHEET FOR PART NUMBER SUFFIX DESIGNATION FOR PACKAGE SIZE AND COLOR.

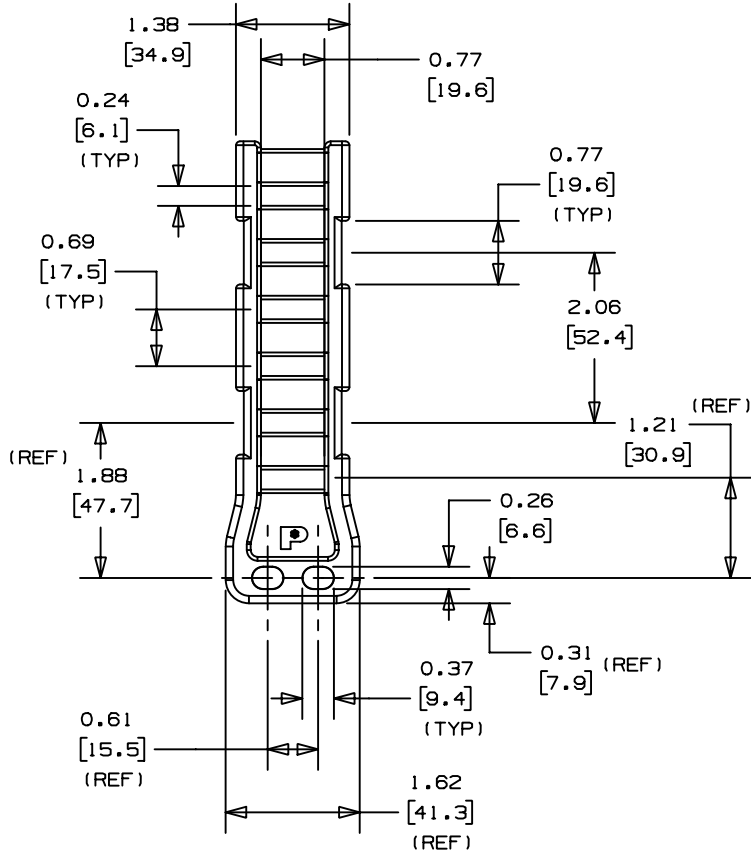
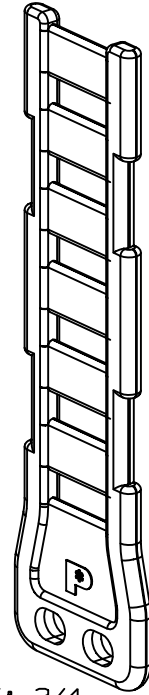

SCALE: 3/4

DIMENSIONS IN BRACKETS ARE METRIC [mm]	
CAD FILENAME/LAYERS G02386BA_PB_PPF2SV_01	
PANDUIT CORP. TINLEY PARK, ILLINOIS	
PAN-POST (FLAT) (PPF2SV-___-__)	
UNLESS OTHERWISE SPECIFIED, DIMENSIONAL TOLERANCES ARE: (.X) ±0.05 (1.3) (.XXX) ±0.010 (0.25) (.XX) ±0.02 (0.5) ANGLES ± 5°	UNLESS OTHERWISE SPECIFIED, ALL DIMENSIONS ARE GIVEN IN INCHES, THIRD ANGLE PROJECTION.
DRAWN BY JAD	MAT'L: 1/2
DATE 6/5/00	NYLON 6/6
CHK'D	DWG GB2386BA A SIZE

REV	DATE	BY	CHK	DESCRIPTION	ECN	R	CUST	SUP
I	8/14/01	LGG		UPDATED AND ADDED 'REF'	GB2386BA	I		
R	6/5/00	JAD		INITIAL RELEASE	GB2386BA	R		